



Price
£230,000

1x  1x  1x 

**Sixteenth Avenue,
Lower Kingswood,
Surrey, KT20**

cubitt&west
Helping you move forwards



Main features

- Lower Kingswood £230,000
- Beautifully finished throughout with bright and spacious kitchen
- Excellent community feel and scenic surroundings
- Ample storage inside
- Parking for 2 cars with driveway
- Ideally located in KT20

Accommodation

GROUND FLOOR

Bathroom: 8'7 x 6'2 (2.62m x 1.88m)
Main Bedroom: 12'4 x 12'3 (3.76m x 3.74m)
Kitchen/Diner/Lounge: 25'9 x 11'4 (7.85m x 3.46m)

OUTSIDE

Two Parking Spaces
Garden

Ground Floor

Approx. 48.7 sq. metres (523.9 sq. feet)

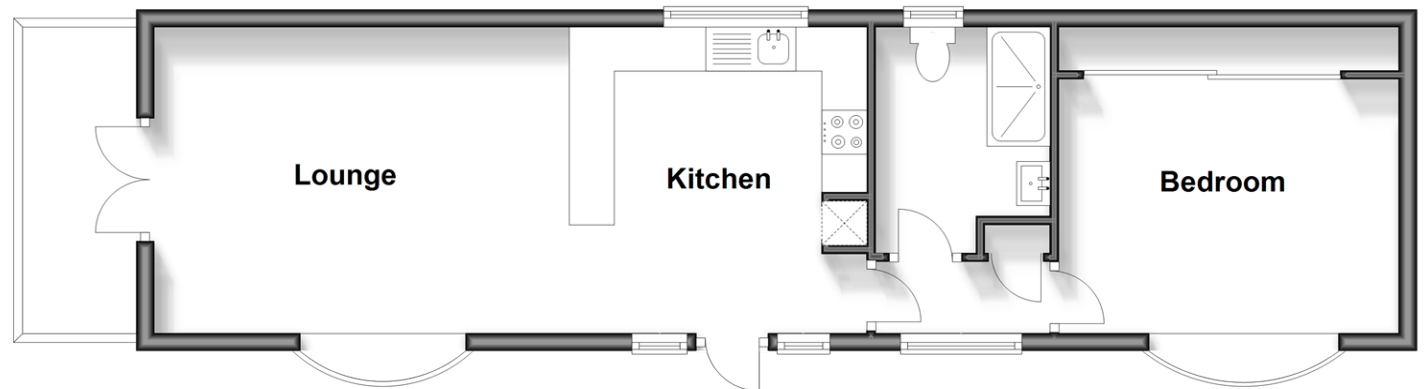

Call Banstead - 01737 352233 ■ cubittandwest.co.uk

■ If buying to let, the energy rating will need to be improved to at least 'E' rating before you can let the property
■ Appliances & services are untested, dimensions are approximate and floor plans are not to scale

■ Legal advice should be taken to verify fixtures/fittings, planning, alterations and/or lease details



20109842/20240418/SA/SB