



**OVER 60?**

Secure this property  
for up to **59% less!**

**Price**

**£230,000**

**Leasehold**

1x  1x  1x 

**Norfolk Mews, South  
Street, Dorking, Surrey,  
RH4**

**cubitt&west**  
Helping you move forwards



## Main features

- Bright, light and airy and ready to move straight into
- Ample communal parking on a first come first served basis
- Central Dorking location
- Perfect for first time buyers or buy to let investors
- Close to stations great for commuters

## Accommodation

### FIRST FLOOR

Entrance Hall

Lounge/Diner: 12'7 x 12'4 (3.84m x 3.76m)

Kitchen: 7'11 x 5'10 (2.41m x 1.78m)

Bedroom: 13'7 x 9'0 (4.14m x 2.75m)

Bathroom

### OUTSIDE

Communal Parking

## First Floor

Approx. 37.1 sq. metres (399.0 sq. feet)

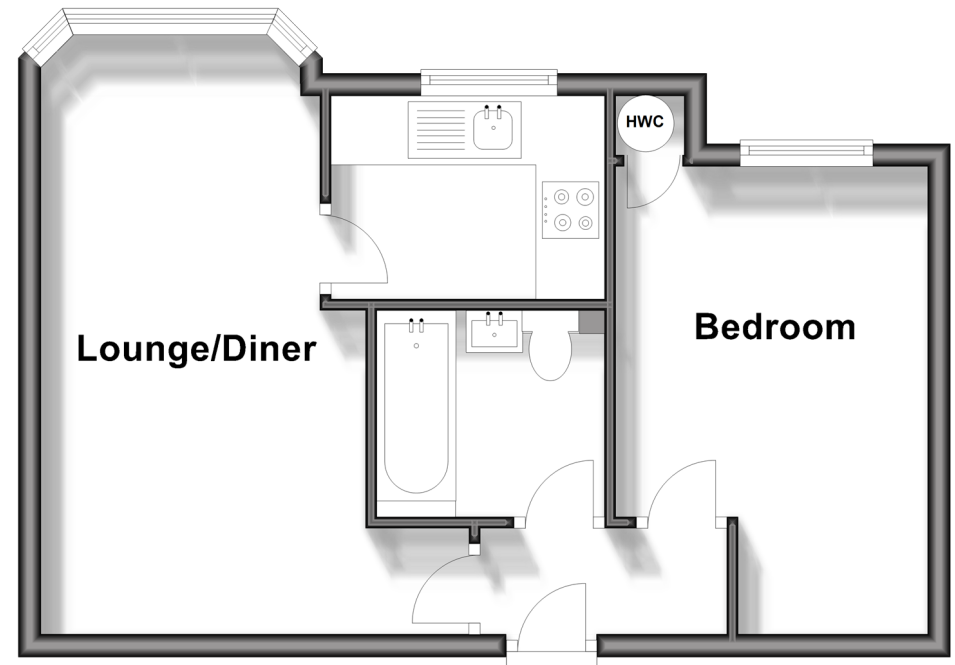

**Call Dorking - 01306 883399 ■ [cubittandwest.co.uk](http://cubittandwest.co.uk)**

■ Legal advice should be taken to verify fixtures/fittings, planning, alterations and/or lease details  
 ■ Through a Homewise Home For Life Plan people aged 60+ can secure this property for up to 59% less, by purchasing a Lifetime Lease.

■ Appliances & services are untested, dimensions are approximate and floor plans are not to scale