



Price
£550,000

Freehold

2x  1x  1x 

**Fairfield Avenue, Horley,
Surrey, RH6**

OVER 60?

Secure this property
for up to **59% less!**



Video Tour available

cubitt&west
Helping you move forwards



Main features

- Walking distance station and town centre
- Large, mature garden
- Garage and off road parking
- Potential to improve and extend (subject to planning permission)
- No chain

Accommodation

GROUND FLOOR

Entrance Porch

Entrance Hall

Lounge/Dining Room: 19'0 x 12'7
(5.80m x 3.84m)

Kitchen: 6'4 x 5'4 (1.93m x 1.63m)

Bedroom 1: 11'9 x 9'9 (3.58m x 2.97m)

Bedroom 2: 11'9 x 8'7 (3.58m x 2.62m)

Bathroom

OUTSIDE

Off Road Parking

Garage

Rear Garden

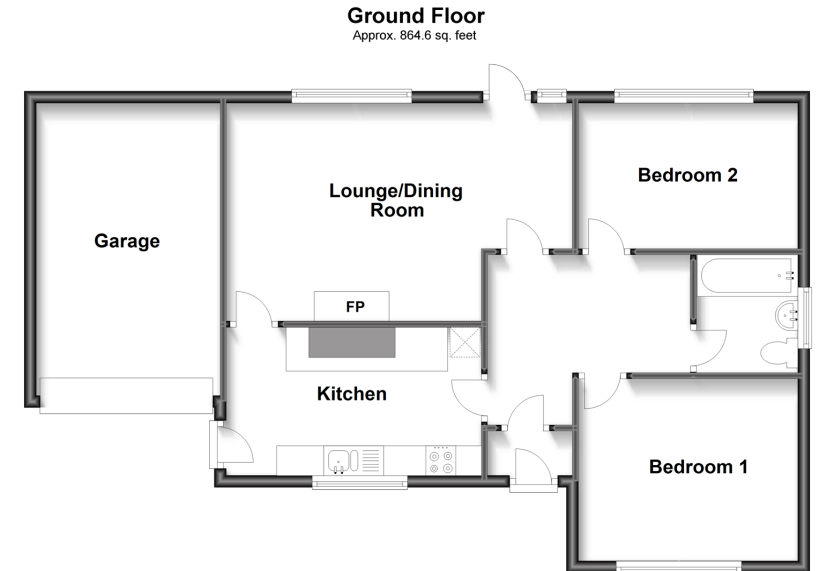

Call Horley - 01293 785338 ■ cubittandwest.co.uk

- Legal advice should be taken to verify fixtures/fittings, planning, alterations and/or lease details
- Appliances & services are untested, dimensions are approximate and floor plans are not to scale
- Through a Homewise Home For Life Plan people aged 60+ can secure this property for up to 59% less, by purchasing a Lifetime Lease.

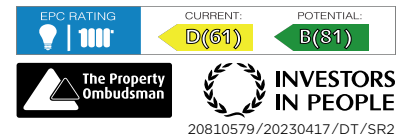

20810579/20230417/DT/SR2