



**OVER 60?**

Secure this property  
for up to **59% less!**

**Price**

**£225,000**

**Leasehold**

2x  1x  1x 

**Sullington Mead,  
Broadbridge Heath,  
West Sussex, RH12**

**cubitt&west**  
Helping you move forwards





## Main features

- Village location just a short walk to local pub, shop and bus routes
- Good size lounge with pleasant outlook
- Plenty of cupboard storage
- Main road network and open countryside nearby
- Great opportunity for first-time buyers!

## Accommodation

### GROUND FLOOR

Entrance Hall  
Storage Cupboard  
Storage Cupboard  
Lounge: 14'5 into alcove x 11'0 (4.40m x 3.36m)  
Bedroom 2: 11'0 x 6'11 (3.36m x 2.11m)  
Bedroom 1: 12'1 x 12'0 (3.69m x 3.66m)  
Bathroom: 6'8 x 5'6 (2.03m x 1.68m)  
Kitchen: 11'2 at widest point x 8'9 at widest point (3.41m x 2.67m)

### OUTSIDE

Front & Rear Garden

### Ground Floor

Approx. 57.4 sq. metres (617.8 sq. feet)

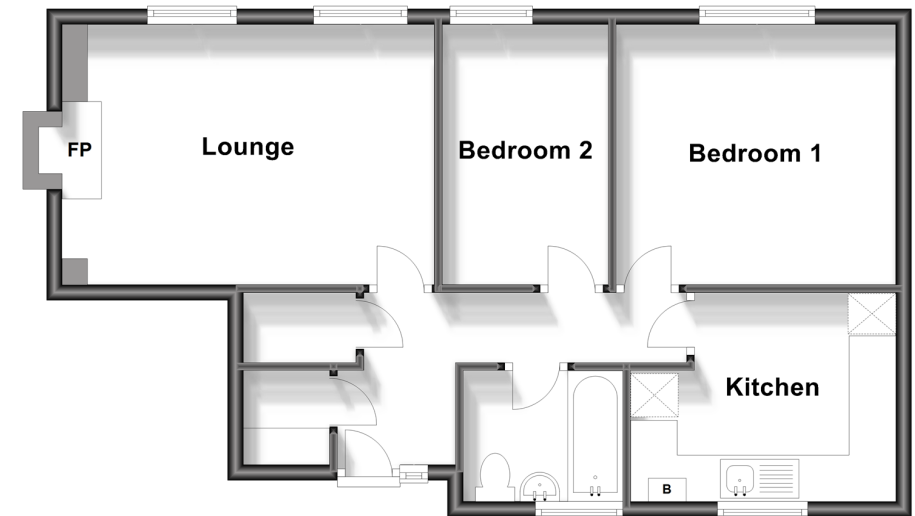

**Call Horsham - 01403 269268 ■ [cubittandwest.co.uk](http://cubittandwest.co.uk)**

■ Legal advice should be taken to verify fixtures/fittings, planning, alterations and/or lease details  
■ Through a Homewise Home For Life Plan people aged 60+ can secure this property for up to 59% less, by purchasing a Lifetime Lease.

■ Appliances & services are untested, dimensions are approximate and floor plans are not to scale