



Price

£90,000

Leasehold

1x  1x  1x 

**Churchfield Court,
Roebuck Close, Reigate,
Surrey, RH2**



Video Tour available

cubitt&west
Helping you move forwards



Main features

- A retirement apartment with a Juliet balcony & no onward chain
- For over 65's only
- Lift access to all floors
- Residents lounge & laundry room
- Communal gardens & communal parking for residents
- Town centre location

Accommodation

FIRST FLOOR

Entrance Hall

Lounge/Diner: 19'4 x 10'6 (5.90m x 3.20m)

Juliet Balcony

Kitchen: 7'3 x 5'4 (2.21m x 1.63m)

Bedroom : 16'1 up to fitted wardrobes x 8'6 maximum (4.91m x 2.59m)

Bathroom: 6'9 x 5'3 (2.06m x 1.60m)

OUTSIDE

Communal Gardens
Communal Parking

First Floor

Approx. 46.8 sq. metres (503.7 sq. feet)

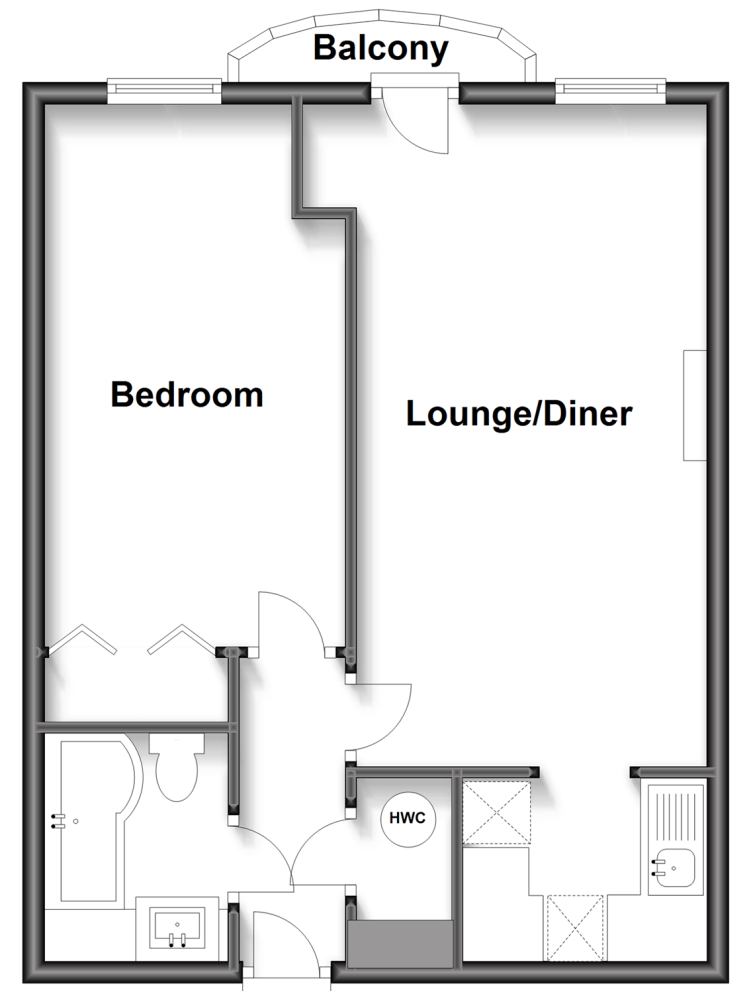

Call Reigate - 01737 222020 ■ cubittandwest.co.uk

- Legal advice should be taken to verify fixtures/fittings, planning, alterations and/or lease details
- Appliances & services are untested, dimensions are approximate and floor plans are not to scale



21613058/20230510/KH/KH