



Guide Price
£185,000

Leasehold

1x  1x  1x 

**Lesbourne Road,
Reigate, Surrey, RH2**

OVER 60?

Secure this property
for up to **59% less!**

cubitt&west
Helping you move forwards



Main features

- A beautifully refurbished, bright and airy maisonette
- No onward chain
- Fitted kitchen with built-in appliances
- Modern shower room, lounge/diner with fireplace
- Great location, next to shops in the heart of Lesbourne village

Accommodation

GROUND FLOOR

Kitchen: 8'5 x 6'0 (2.57m x 1.83m)

Lounge/Diner: 12'0 x 10'0 (3.66m x 3.05m)

Bedroom : 9'10 x 7'1 (3.00m x 2.16m)

Shower Room: 6'0 x 5'0 (1.83m x 1.53m)

Ground Floor

Approx. 31.8 sq. metres (342.7 sq. feet)

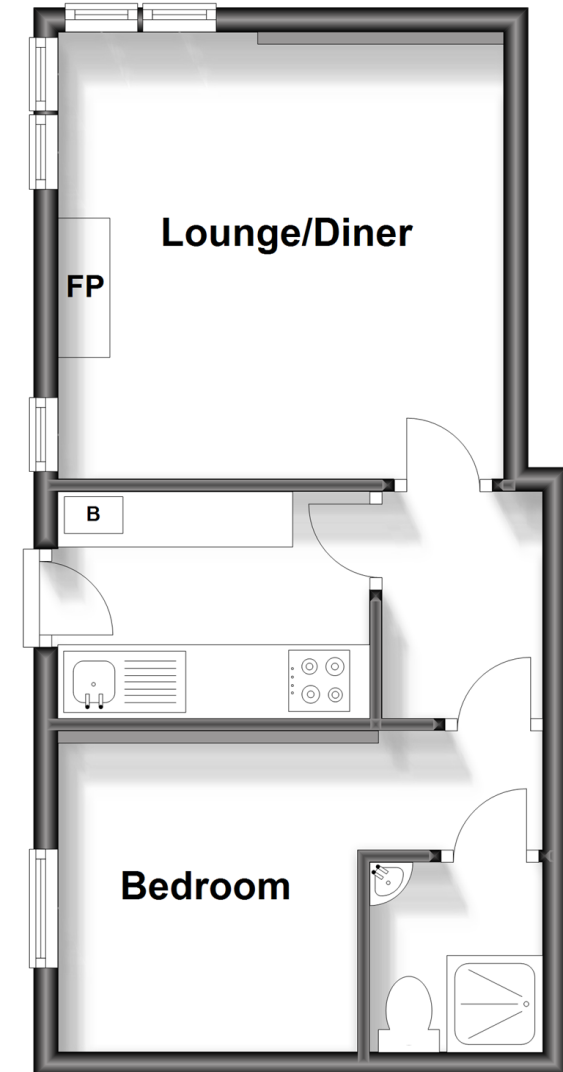

Call Reigate - 01737 222020 ■ cubittandwest.co.uk

- Legal advice should be taken to verify fixtures/fittings, planning, alterations and/or lease details
- Appliances & services are untested, dimensions are approximate and floor plans are not to scale
- Through a Homewise Home For Life Plan people aged 60+ can secure this property for up to 59% less, by purchasing a Lifetime Lease.



21613242/20231020/JB1/JB1