



Guide Price
£215,000

Leasehold

1x  1x  1x 

**Stoneworth Court,
Birchanger Road, South
Norwood, London, SE25**

OVER 60?

Secure this property
for up to **59% less!**



Video Tour available

cubitt&west
Helping you move forwards



Main features

- Excellent ground floor flat in ideal location
- Spacious lounge/diner with separate kitchen
- Garage en-bloc and allocated parking space
- Situated close to East Croydon station and local amenities
- Offered chain free

Accommodation

GROUND FLOOR

Entrance Hall

Lounge/Diner: 16'0 up to door
recess x 10'2 (4.88m x 3.10m)

Kitchen: 9'6 x 6'6 (2.90m x 1.98m)

Bedroom 1: 14'9 x 8'10 (4.50m x 2.69m)

Bathroom

OUTSIDE

Communal Gardens

Garage En-Bloc

Ground Floor

Approx. 45.4 sq. metres (489.0 sq. feet)

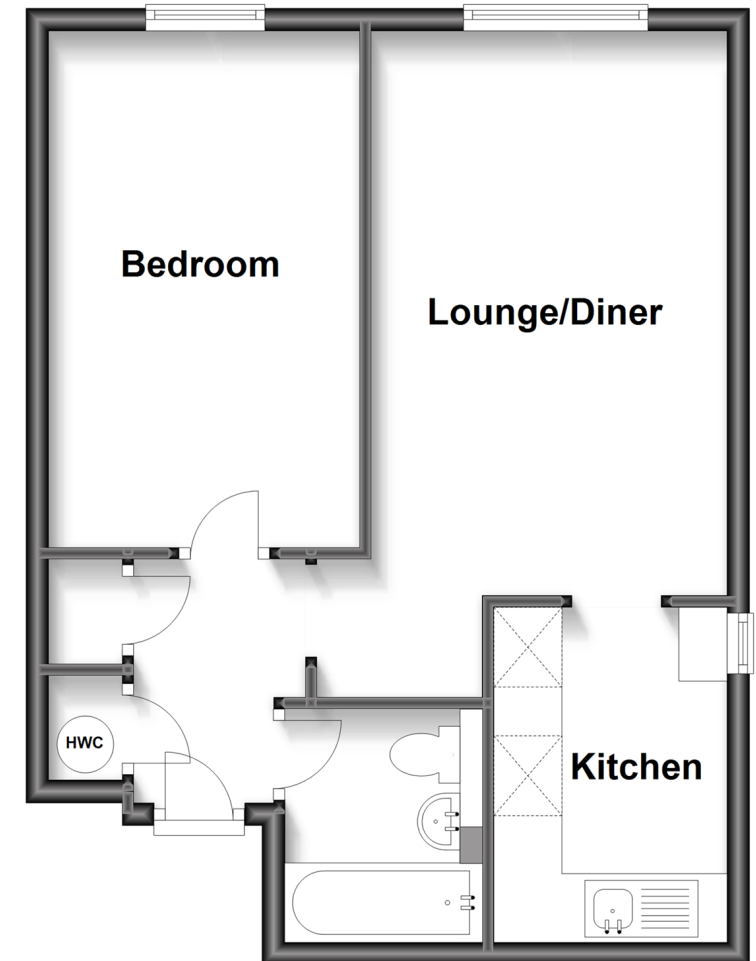

Call Shirley - 020 8654 3037 ■ cubittandwest.co.uk

- A private rental licensing scheme applies to some properties in this area, please contact us before proceeding
- Legal advice should be taken to verify fixtures/fittings, planning, alterations and/or lease details
- Appliances & services are untested, dimensions are approximate and floor plans are not to scale
- Through a Homewise Home For Life Plan people aged 60+ can secure this property for up to 59% less, by purchasing a Lifetime Lease.

