



Price

£220,000

Leasehold

1x  1x  1x 

**Mill House, River View
Mews, Beddington,
Croydon, Surrey, CR0**

cubitt&west
Helping you move forwards



Main features

- Brand new ground floor apartment with its own entrance and courtyard
- Under floor heating
- Finished to a high standard throughout
- Perfect for first time purchase or investment
- Allocated parking space

Accommodation

GROUND FLOOR

Entrance Hall

Lounge/Kitchen/Diner: 18'5 x 10'4 (5.62m x 3.15m)

Shower Room: 9'9 x 3'9 (2.97m x 1.14m)

Bedroom : 8'6 x 8'6 into fitted wardrobes (2.59m x 2.59m)

OUTSIDE

Allocated Parking Space

Ground Floor

Approx. 30.2 sq. metres (325.3 sq. feet)

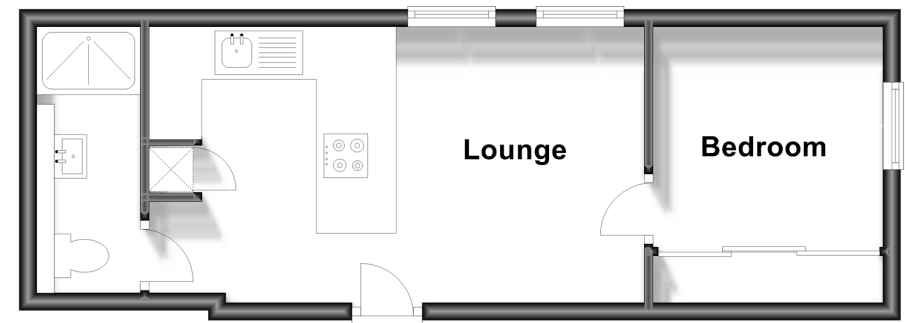

Call Wallington - 020 8647 0011 ■ cubittandwest.co.uk

■ A private rental licensing scheme applies to some properties in this area, please contact us before proceeding

■ Appliances & services are untested, dimensions are approximate and floor plans are not to scale

■ Legal advice should be taken to verify fixtures/fittings, planning, alterations and/or lease details



22117189/20230512/JC/DK