



Guide Price
£290,000

Leasehold

2x  1x  1x 

**Green Wrythe Lane,
Carshalton, Surrey, SM5**

OVER 60?

Secure this property
for up to **59% less!**

cubitt&west
Helping you move forwards



Main features

- **Fantastic ground floor maisonette**
- **Direct access to your own private garden**
- **Perfect for a first-time purchase or investment**
- **Close to good transport links and amenities**
- **Offering spacious accommodation throughout**

Accommodation

GROUND FLOOR

Entrance Hall

Lounge: 13'7 x 11'9 (4.14m x 3.58m)

Kitchen: 8'5 x 5'11 (2.57m x 1.80m)

Bedroom 1: 12'6 x 12'3 (3.81m x 3.74m)

Bedroom 2: 7'8 x 7'3 (2.34m x 2.21m)

Bathroom

Separate Toilet

OUTSIDE

Rear Garden

Ground Floor
Approx. 55.8 sq. metres (600.6 sq. feet)

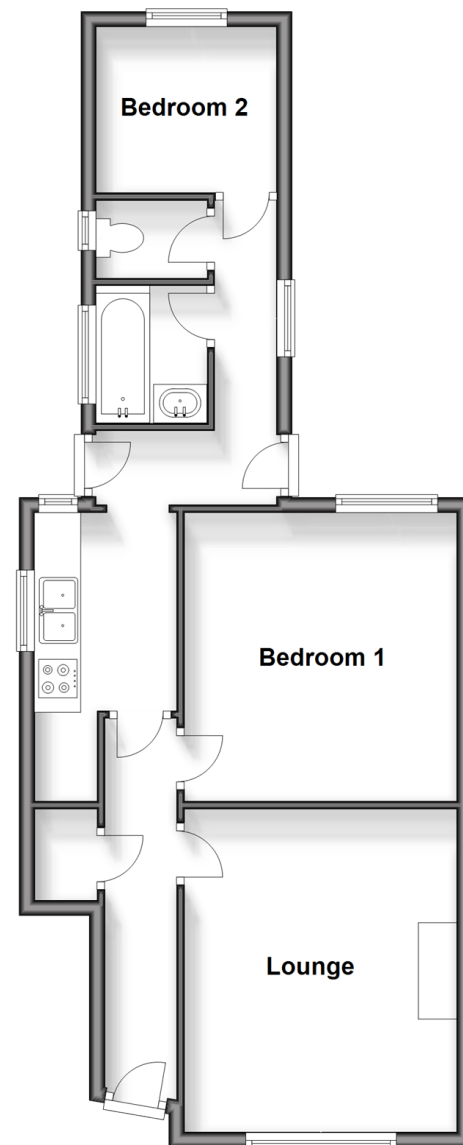

Call Wallington - 020 8647 0011 ■ cubittandwest.co.uk

- A private rental licensing scheme applies to some properties in this area, please contact us before proceeding
- Legal advice should be taken to verify fixtures/fittings, planning, alterations and/or lease details
- Appliances & services are untested, dimensions are approximate and floor plans are not to scale
- Through a Homewise Home For Life Plan people aged 60+ can secure this property for up to 59% less, by purchasing a Lifetime Lease.



22117347/20240409/GG/DK