



OVER 60?

Secure this property
for up to **59% less!**

Price
£315,000

Freehold

2x  1x  1x 

**Bluebell Way, Burgess
Hill, West Sussex, RH15**

cubitt&west
Helping you move forwards



Main features

- Cul-de-sac location
- Both bedrooms are of double size, one of which has a large built-in wardrobe
- Secluded sunny garden
- 2 x Allocated parking spaces
- Walking distance to the Triangle swimming pool & leisure centre

Accommodation

GROUND FLOOR

Hallway
Cloakroom
Lounge/Dining Room: 15'4 x 11'10 (4.68m x 3.61m)
Kitchen: 10'4 x 5'6 (3.15m x 1.68m)

FIRST FLOOR

Landing
Bedroom 1: 12'0 x 9'2 (3.66m x 2.80m)
Bedroom 2: 11'1 x 9'7 (3.38m x 2.92m)
Bathroom

OUTSIDE

Front & Rear Gardens
2x Allocated Parking Spaces

Ground Floor

Approx. 28.4 sq. metres (305.7 sq. feet)



First Floor

Approx. 28.4 sq. metres (305.7 sq. feet)

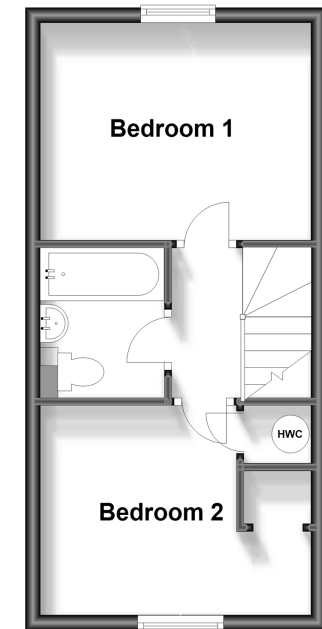

Call Haywards Heath - 01444 411132 ■ cubittandwest.co.uk

■ Legal advice should be taken to verify fixtures/fittings, planning, alterations and/or lease details
■ Through a Homewise Home For Life Plan people aged 60+ can secure this property for up to 59% less, by purchasing a Lifetime Lease.

■ Appliances & services are untested, dimensions are approximate and floor plans are not to scale



22705576/20230615/DD/DD