



Price

£160,000

Leasehold

2x  1x  1x 

**Eastwood Lodge,
Eastwood Road,
Bramley, Guildford,
Surrey, GU5**

OVER 60?

Secure this property
for up to **59% less!**



Video Tour available

cubitt&west
Helping you move forwards



Main features

- Well presented ground floor flat for the over 55s
- Tranquil cul-de-sac location
- Lounge/diner with doors opening to lovely communal gardens
- Refurbished shower room
- Off road parking
- Offered with no onward chain

Accommodation

GROUND FLOOR

Entrance Hall

Lounge/Diner: 15'6 x 10'11 (4.73m x 3.33m)

Kitchen: 9'0 x 6'11 (2.75m x 2.11m)

Bedroom 1: 11'4 x 9'4 (3.46m x 2.85m)

Bedroom 2: 11'4 x 5'11 (3.46m x 1.80m)

Shower Room

OUTSIDE

Communal Gardens

Parking Area

Ground Floor

Approx. 46.0 sq. metres (495.2 sq. feet)

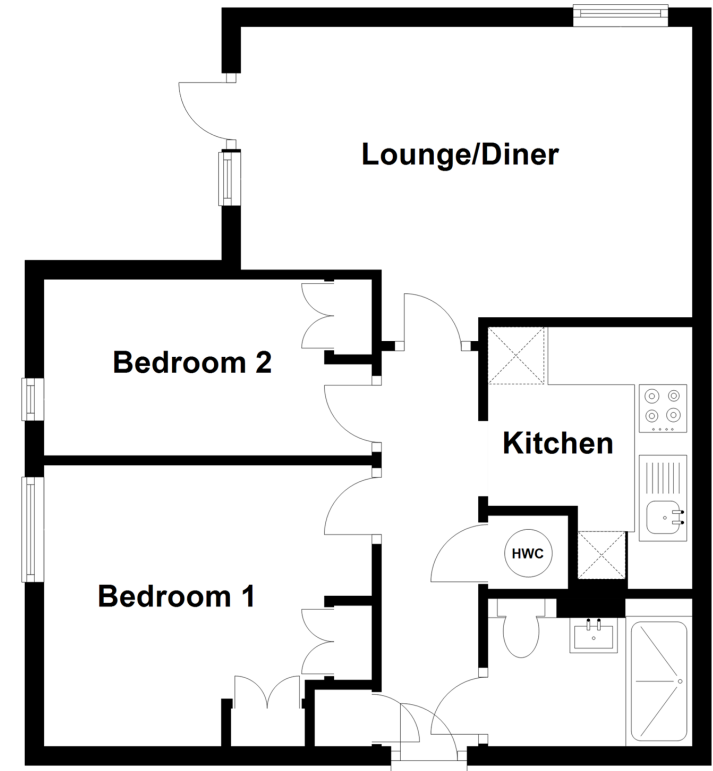

Call Cranleigh - 01483 271567 ■ cubittandwest.co.uk

- Legal advice should be taken to verify fixtures/fittings, planning, alterations and/or lease details
- Appliances & services are untested, dimensions are approximate and floor plans are not to scale
- Through a Homewise Home For Life Plan people aged 60+ can secure this property for up to 59% less, by purchasing a Lifetime Lease.

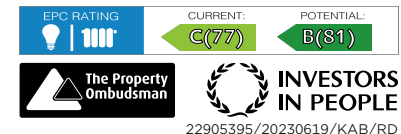

22905395/20230619/KAB/RD