



Price
£250,000

Leasehold

2x  1x  1x 

**Woodview, Arundel,
West Sussex BN18**

OVER 60?

Secure this property
for up to **59% less!**

cubitt&west
Helping you move forwards



Main features

- Well appointed ground floor maisonette
- Stylish modern kitchen with French doors opening onto courtyard
- Two good sized bedrooms with home office potential
- Smartly decorated throughout
- Located short walk from bustling historic town centre with shops, restaurants and schools

Accommodation

GROUND FLOOR

Entrance Hall

Lounge : 18'3 x 13'3 (5.57m x 4.04m)

Bedroom 1: 11'5 x 10'10 (3.48m x 3.30m)

Bedroom 2: 13'5 x 8'11 (4.09m x 2.72m)

Kitchen : 14'3 x 8'11 (4.35m x 2.72m)

Shower Room : 6'0 x 3'9 (1.83m x 1.14m)

OUTSIDE

Patio Garden

Ground Floor

Approx. 61.7 sq. metres (663.7 sq. feet)

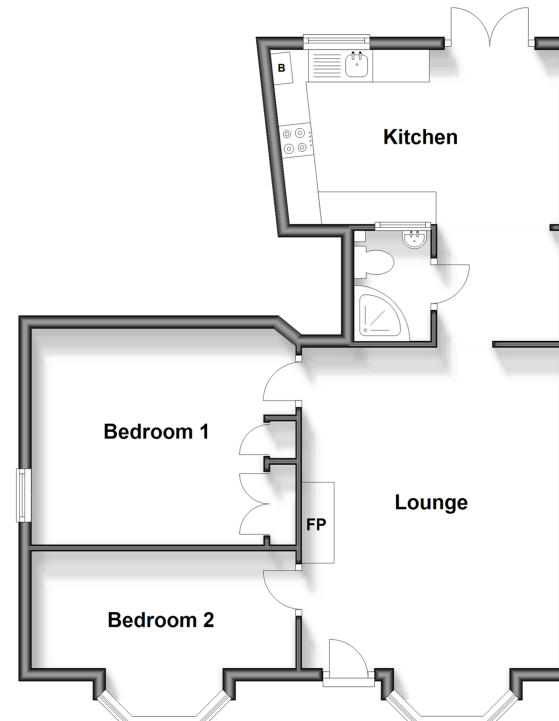

Call Arundel - 01903 884420 ■ cubittandwest.co.uk

■ Legal advice should be taken to verify fixtures/fittings, planning, alterations and/or lease details
 ■ Through a Homewise Home For Life Plan people aged 60+ can secure this property for up to 59% less, by purchasing a Lifetime Lease.

■ Appliances & services are untested, dimensions are approximate and floor plans are not to scale