



Price

£50,000

1x  1x  1x 

**The Oaks, Greatham,
Liss, Hampshire, GU33**



Video Tour available

cubitt&west
Helping you move forwards



Main features

- Secluded and rural retirement park home site
- Well presented throughout
- Age restricted
- Located in the delightful village of Greatham
- Garden area
- Residence parking

Accommodation

GROUND FLOOR

Entrance

Lounge/Kitchen: 16'6 x 9'9 (5.03m x 2.97m)

Bathroom: 7'2 x 5'0 (2.19m x 1.53m)

Bedroom: 9'9 x 7'0 (2.97m x 2.14m)

OUTSIDE

Rear Garden

Residence Parking

Ground Floor

Approx. 24.9 sq. metres (268.5 sq. feet)

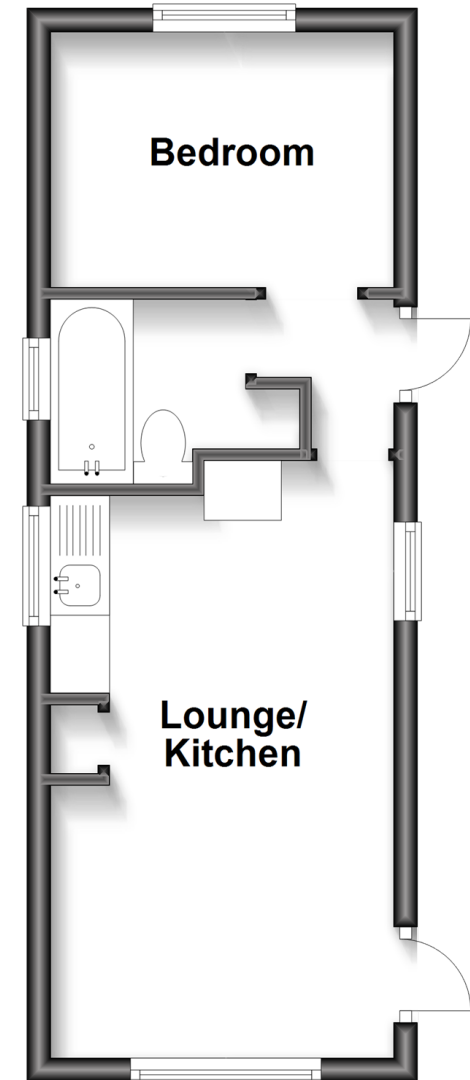

Call Petersfield - 01730 262931 ■ cubittandwest.co.uk

- If buying to let, the energy rating will need to be improved to at least 'E' rating before you can let the property
- Legal advice should be taken to verify fixtures/fittings, planning, alterations and/or lease details
- Appliances & services are untested, dimensions are approximate and floor plans are not to scale



23316423/20240501/NJ21/YH