



Price

£189,950

3x  1x  1x 

**Whitehill Park Bordon,
Whitehill, Bordon,
Hampshire, GU35**



Video Tour available

cubitt&west
Helping you move forwards



Main features

- Popular development for the over 55s
- Spacious living accommodation
- Driveway parking
- Maintained to a high standard by the current vendors
- Good size private gardens

Accommodation

GROUND FLOOR

Hallway

Lounge/Diner: 19'4 x 15'8 (5.90m x 4.78m)

Kitchen: 12'7 x 9'6 (3.84m x 2.90m)

Bedroom 1: 9'8 x 9'7 (2.95m x 2.92m)

Bedroom 2: 9'6 x 8'2 (2.90m x 2.49m)

Bedroom 3: 6'8 x 5'9 (2.03m x 1.75m)

Shower Room

OUTSIDE

Front Garden

Rear Garden

Driveway Parking

Ground Floor

Approx. 65.1 sq. metres (701.3 sq. feet)

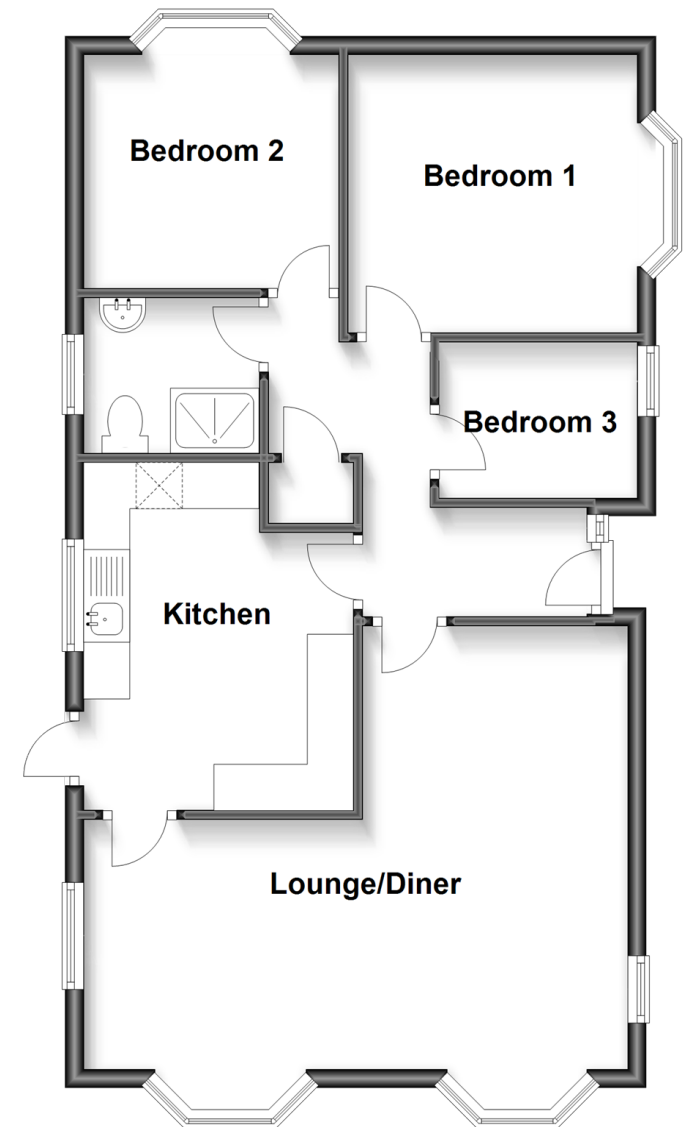

Call Petersfield - 01730 262931 ■ cubittandwest.co.uk

- If buying to let, the energy rating will need to be improved to at least 'E' rating before you can let the property
- Legal advice should be taken to verify fixtures/fittings, planning, alterations and/or lease details
- Appliances & services are untested, dimensions are approximate and floor plans are not to scale



23316484/20230220/DK/DK