



OVER 60?

Secure this property
for up to **59% less!**

Price

£180,000

Leasehold

1x  1x  1x 

**Marylebone House,
Marketfield Road,
Redhill, Surrey, RH1**

cubitt&west
Helping you move forwards



Main features

- Generously proportioned apartment with a private patio terrace
- Fabulously modern and refurbished to a very high standard throughout
- Convenient Town Centre location
- Great choice for commuters with Redhill train station close by
- Excellent train links into Central London

Accommodation

SECOND FLOOR

Entrance Hall

Kitchen / Lounge: 18'0 x 14'4
(5.49m x 4.37m)

Bedroom: 9'7 x 9'3 (2.92m x 2.82m)

Shower Room : 7'3 x 5'0 (2.21m x 1.53m)

OUTSIDE

Private Terrace

Second Floor

Approx. 35.2 sq. metres (378.4 sq. feet)

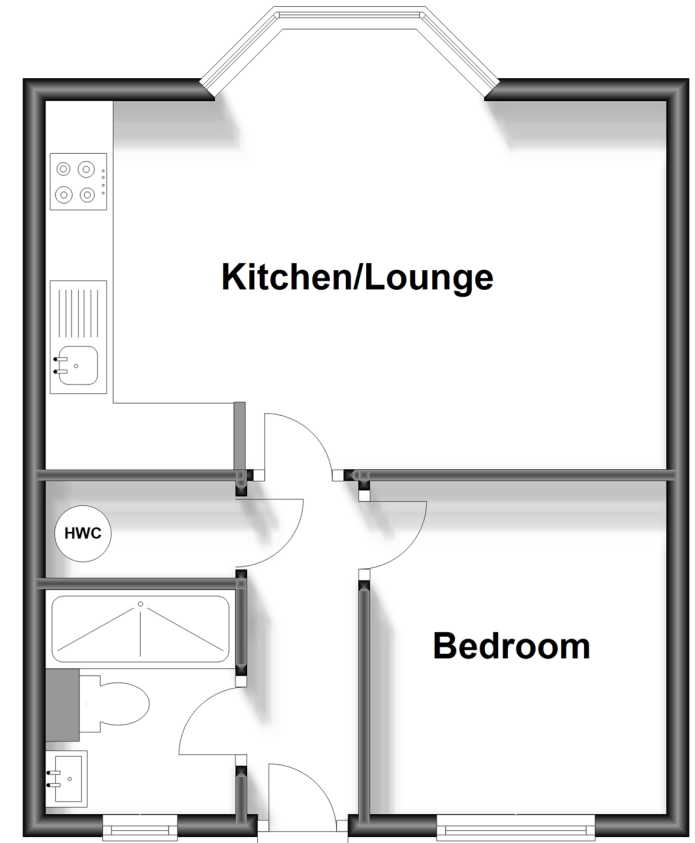

Call Redhill - 01737 778866 ■ cubittandwest.co.uk

- Legal advice should be taken to verify fixtures/fittings, planning, alterations and/or lease details
- Appliances & services are untested, dimensions are approximate and floor plans are not to scale
- Through a Homewise Home For Life Plan people aged 60+ can secure this property for up to 59% less, by purchasing a Lifetime Lease.



23411133/20231025/RJ/JB