



**OVER 60?**

Secure this property  
for up to **59% less!**

**Price**

**£334,950**

**Freehold**

3x  1x  1x 

**Hilders Farm Close,  
Crowborough, East  
Sussex, TN6**

**cubitt&west**  
Helping you move forwards





## Main features

- Tucked away in a peaceful location
- Spacious lounge with useful storage cupboard
- Well equipped kitchen with pretty wooded outlook
- Bright and airy accommodation throughout
- Good sized garden offering a good degree of privacy

## Accommodation

### GROUND FLOOR

Hall

Lounge: 15'2 x 14'5 (4.63m x 4.40m)

Kitchen: 9'9 x 8'10 (2.97m x 2.69m)

### FIRST FLOOR

Landing

Bedroom 1: 12'3 x 8'8 (3.74m x 2.64m)

Bedroom 2: 12'2 x 7'8 (3.71m x 2.34m)

Bedroom 3: 7'7 x 6'2 (2.31m x 1.88m)

Bathroom

### OUTSIDE

Front and Rear Gardens

### Ground Floor

Approx. 34.8 sq. metres (375.1 sq. feet)

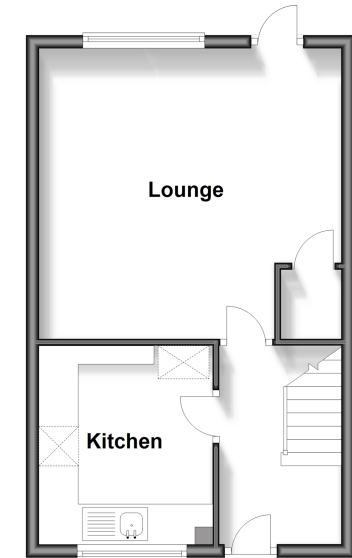

### First Floor

Approx. 34.8 sq. metres (375.1 sq. feet)

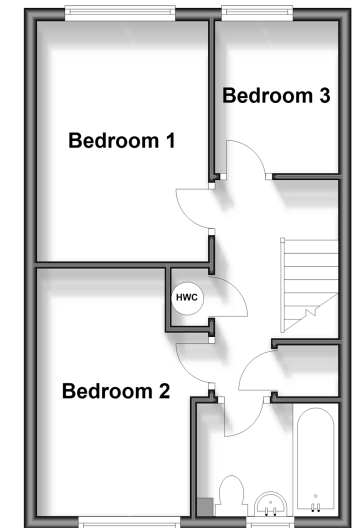

**Call Crowborough - 01892 613361 ■ [cubittandwest.co.uk](http://cubittandwest.co.uk)**

- If buying to let, the energy rating will need to be improved to at least 'E' rating before you can let the property
- Legal advice should be taken to verify fixtures/fittings, planning, alterations and/or lease details
- Appliances & services are untested, dimensions are approximate and floor plans are not to scale
- Through a Homewise Home For Life Plan people aged 60+ can secure this property for up to 59% less, by purchasing a Lifetime Lease.



24204021/20240513/JTA/JF