



Price

£130,000

Leasehold

2x  1x  1x 

Plot 26, Portland Close, Langley,
Maidstone, Kent, ME17 3YU

cubitt&west
Helping you move forwards



Main features

- Available for shared ownership from a 25% share
- Contemporary fitted kitchen and bathroom
- Private rear garden with storage shed
- RESERVING NOW!

Accommodation

GROUND FLOOR

Kitchen: 11'0 x 8'8 (3.36m x 2.64m)
Living Room: 16'9 x 13'2 (5.11m x 4.02m)
Cloakroom: 6'4 x 3'7 (1.93m x 1.09m)

FIRST FLOOR

Bedroom 1: 13'5 x 11'4 (4.09m x 3.46m)
Bedroom 2: 13'5 x 13'0 (4.09m x 3.97m)
Bathroom: 7'1 x 6'4 (2.16m x 1.93m)

OUTSIDE

Private rear garden
Allocated Parking

Rosewood, Maidstone, Kent

The Baker 2 Bedroom Mid-Terrace House

Plots 26, 126, 128 and 134

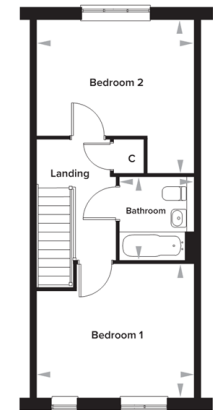
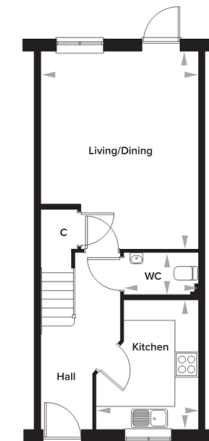

Ground Floor

Kitchen	2637mm x 3350mm	8' 8" x 11' 0"
Living/Dining	4070mm x 5117mm	13' 2" x 16' 9"
WC	1924mm x 1082mm	6' 4" x 3' 7"

First Floor

Bedroom 1	4080mm x 3462mm	13' 5" x 11' 4"
Bedroom 2	4080mm x 3984mm	13' 5" x 13' 0"
Bathroom	1932mm x 2162mm	6' 4" x 7' 1"

Please note dimensions are approximate © 50mm and are not intended to be used for carpet sizes, appliance spaces or furniture items.

Call Shared Ownership - 01403 602681 ■ cubittandwest.co.uk

■ Legal advice should be taken to verify fixtures/fittings, planning, alterations and/or lease details

■ Appliances & services are untested, dimensions are approximate and floor plans are not to scale



24302213/20240112/MIC/MIC