



Guide Price
£360,000

Leasehold

2x  1x  1x 

**Buckingham Road,
Brighton, East Sussex,
BN1**

cubitt&west
Helping you move forwards



Main features

- Period spacious apartment, close to Seven Dials
- Ready to move into
- Popular West Hill conservation area
- Close to Brighton station
- No onward chain

Accommodation

FIRST FLOOR

Entrance Hall

Lounge : 17'1 x 12'2 (5.21m x 3.71m)

Kitchen : 10'2 x 7'10 (3.10m x 2.39m)

Bedroom 1 : 15'5 x 9'10 (4.70m x 3.00m)

Bedroom 2 : 13'9 x 6'11 (4.19m x 2.11m)

Bathroom

First Floor

Approx. 55.1 sq. metres (592.6 sq. feet)

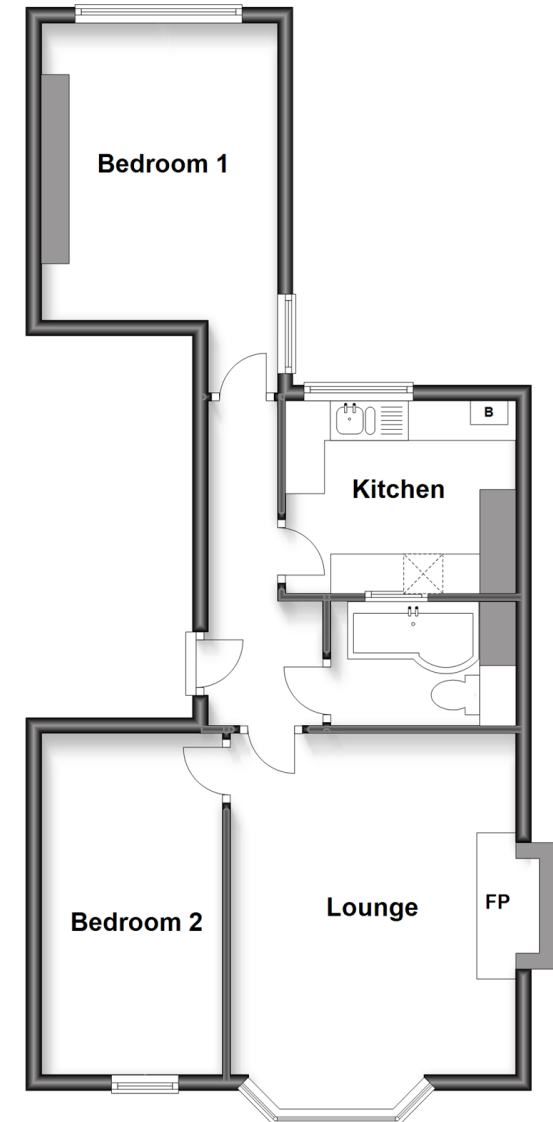

Call Central Brighton - 01273 820600 ■ cubittandwest.co.uk

- Legal advice should be taken to verify fixtures/fittings, planning, alterations and/or lease details
- Appliances & services are untested, dimensions are approximate and floor plans are not to scale



32412433/20220921/AF/JR