



Price

£370,000

Freehold

2x  1x  1x 

**Chayle Gardens, Selsey,
Chichester, West
Sussex, PO20**

OVER 60?

Secure this property
for up to **59% less!**

cubitt&west
Helping you move forwards



Main features

- Detached bungalow in desirable, cul-de-sac location
- Modern fittings & appliances
- Bright & spacious accommodation throughout
- Enclosed, sunny rear garden
- Only a short walk to the seafront & high street

Accommodation

GROUND FLOOR

Hallway

Lounge/Kitchen: (L-shaped) 15'9 x 11'1 (4.80m x 3.38m) plus 9'10 x 11'0 (3.00m x 3.36m)

Conservatory: 12'4 x 8'9 (3.76m x 2.67m)

Bedroom 1: 11'3 x 11'2 (3.43m x 3.41m)

Bedroom 2: 9'1 x 8'2 (2.77m x 2.49m)

Bathroom

OUTSIDE

Garage & Off Road Parking

Front & Rear Gardens

Shed

Ground Floor

Approx. 68.5 sq. metres (736.9 sq. feet)

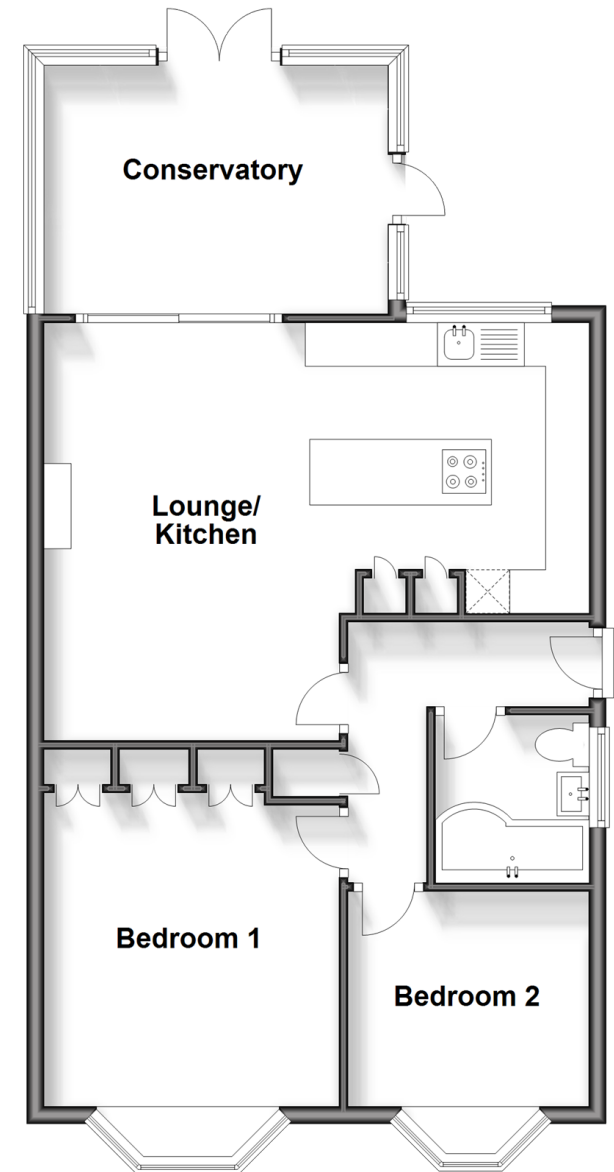

Call Chichester - 01243 786581 ■ cubittandwest.co.uk

- Legal advice should be taken to verify fixtures/fittings, planning, alterations and/or lease details
- Appliances & services are untested, dimensions are approximate and floor plans are not to scale
- Through a Homewise Home For Life Plan people aged 60+ can secure this property for up to 59% less, by purchasing a Lifetime Lease.



40414935/20240502/JH/JH