



Price

£175,000

Leasehold

2x  1x  1x 

**Albert Road, Southsea,
Hampshire, PO4**

OVER 60?

Secure this property
for up to **59% less!**



Video Tour available

cubitt&west
Helping you move forwards



Main features

- Brilliant opportunity for first time buyers or investors alike
- Spacious kitchen with space for a dining table
- Offered with no forward chain
- Private entrance and private rear garden
- Central location, close to all amenities, bars and restaurants

Accommodation

FIRST FLOOR

Entrance Hallway

Kitchen: 12'4 x 10'2 (3.76m x 3.10m)

Lounge: 16'7 x 10'3 (5.06m x 3.13m)

Bedroom 1: 12'3 x 10'5 (3.74m x 3.18m)

Bathroom

Bedroom 2: 9'6 x 8'8 (2.90m x 2.64m)

OUTSIDE

Rear Garden

First Floor

Approx. 57.8 sq. metres (621.6 sq. feet)

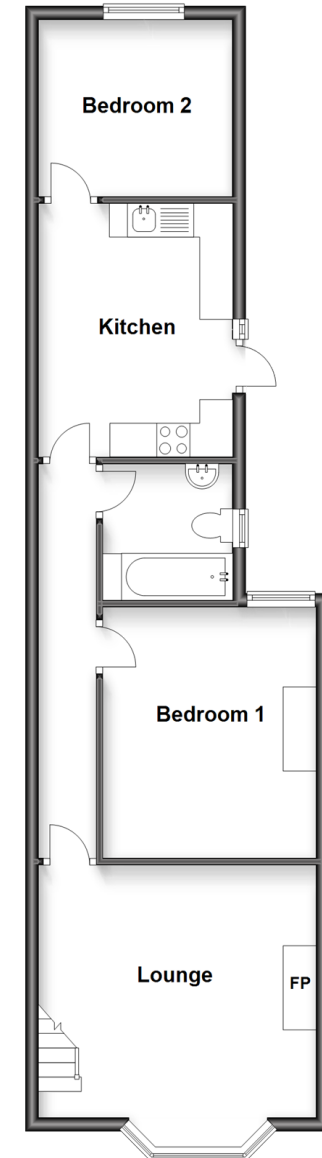

Call Southsea - 023 9229 6396 ■ cubittandwest.co.uk

- The seller is a person connected with Cubitt & West as defined in the Estate Agents Act 1979
- Legal advice should be taken to verify fixtures/fittings, planning, alterations and/or lease details
- Appliances & services are untested, dimensions are approximate and floor plans are not to scale
- Through a Homewise Home For Life Plan people aged 60+ can secure this property for up to 59% less, by purchasing a Lifetime Lease.



42226732/20230207/MO1/SA